

DRAWING NO. C340TSXX	REV AA	Customer Drawing	REVISION HISTORY			
			REV	DESCRIPTION (ECO)	DATE	APPROVED
			Y	UPDATE BOM SHEET 2. PURPLE COLOR P/N UPDATE ECO 12207	06/08/23	SR
			AA	ADD SUFFIX "X" FOR HOSTAFORM MAT. ECO 12941	02/19/25	DK

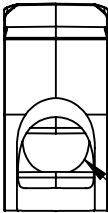
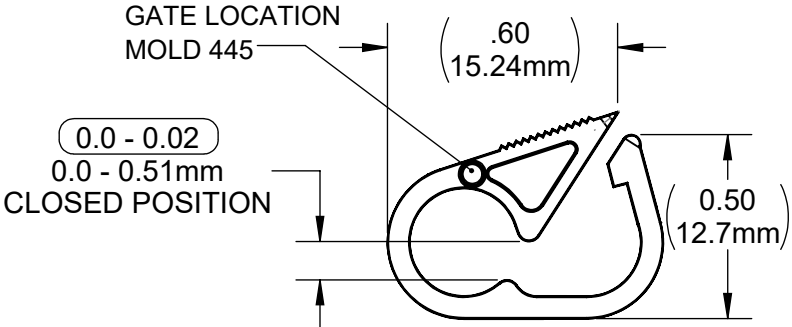
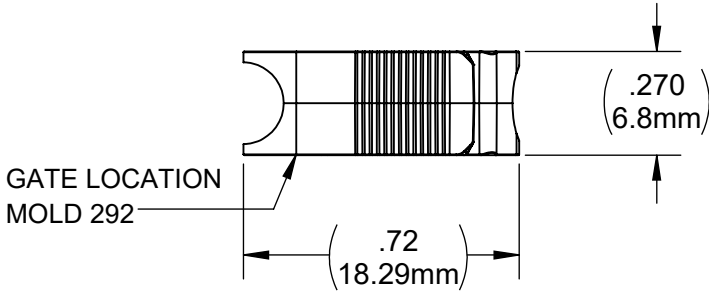

SEE NOTE 3.

NOTES:

- 1st SUFFIX "X" INDICATES MATERIAL:
HF - HOSTAFORM
NONE - CELCON
P - POLYPROPYLENE
- 2nd SUFFIX "X" INDICATES COLOR:

HOSTAFORM	CELCON	POLYPROPYLENE
HFB - BLUE	B - BLUE	PB - BLUE
HFN - NATURAL	N - NATURAL	PR - RED
HFR - RED	R - RED	PW - WHITE
HFPL - PURPLE	PL - PURPLE	
HFYL - YELLOW	YL - YELLOW	
HFCR - CREAM	CR - CREAM	
HFBK - BLACK	BK - BLACK	

- CRITICAL DIMENSIONS ARE CIRCLED AND SUBJECT TO INSPECTION. DIMENSIONS IN PARENTHESES ARE FOR REFERENCE ONLY. ALL DIMENSIONS ARE IN INCHES WITH NOMINAL IN MILLIMETERS BELOW.
- MAX TUBING DIA. (0.16").
- HR TUBING CLAMPS ARE SINGLE PATIENT USE MEDICAL COMPONENTS INTENDED TO BE INCLUDED AS PART OF THE FINISHED DEVICE, I.E. IV ADMINISTRATION SETS. HR TUBING CLAMPS ARE MANUFACTURED TO HR SPECIFICATIONS, SOLD BULK, NON-STERILE TO OEMS. BECAUSE THE CONFIGURATIONS OF IV TUBING VARY DRAMATICALLY, HR CANNOT MAKE ANY PARTICULAR CLAIMS. CUSTOMERS MUST VALIDATE CLAMPS FOR THEIR INTENDED USE, ENSURING THAT THE CLAMPS EFFECTIVELY OCCLUDE THE INHERENT VARIATION OF THE PARTICULAR TUBING EMPLOYED BY THE CUSTOMER AGAINST THE CLOSED GAP RANGE PROVIDED ON HR'S SPECIFICATIONS. OEM MANUFACTURING PROCESSES (SUCH AS ASSEMBLY PROCESSES, PACKAGING AND STERILIZATION) CAN SIGNIFICANTLY ALTER THE CLAMPS' FUNCTIONALITY; THEREFORE, HR CANNOT GUARANTEE THE PERFORMANCE OF THE FINAL CONFIGURATION.

QUALITY CRITERIA

O.D. FLASH 0.015 MAX. (0.4MM)
GATE VESTIGE 0.01 MAX. (0.3MM)
EMBEDDED PARTICLES, BUBBLES, SPOTS, STAINS: 0.3mm ² MAX. NO MORE THAN 5 PER PART.

MOLDED PARTS:
GATES, PARTING LINES, AND FLASH PER QUALITY CRITERIA

PROPRIETARY AND CONFIDENTIAL
THE INFORMATION CONTAINED IN THIS DRAWING IS SOLE PROPERTY OF HALKEY-ROBERTS CORPORATION ST. PETERSBURG, FL. ANY REPRODUCTION IN PART OR AS A WHOLE WITHOUT THE WRITTEN PERMISSION OF HALKEY-ROBERTS CORPORATION IS PROHIBITED.

DRAWN BY M.S.	DATE 04/04/96
APPROVED BY J.W.	DATE 04/04/96
MATERIAL SEE NOTES PG 2.	
FINISH N/A	
UNLESS OTHERWISE SPECIFIED: DIMENSIONS ARE IN INCHES TOLERANCES: ANGULAR: ± 1° TWO PLACE DECIMAL ± .01 THREE PLACE DECIMAL ± .005	THIRD ANGLE PROJECTION

HR® Halkey-Roberts®			
TUBING CLAMP MICRO			
SIZE A	DRAWING NO. C340TSXX	REV AA	
SCALE 2:1	DO NOT SCALE DRAWING		SHEET 1 OF 2

Bill of Materials							
Hostaform				Celcon M270		Gamma Stable Polypropylene P5M6K-080	
Blue	MT24U01 MT24U01CG3671K20			Blue	Celcon M90-07 CG3671K20		Blue Polyone Blue CABS18446
Natural	MT24U01			Natural	N/A		Red Polyone Red 8AR313619MB
Red	MT24U01 MT24U01CS3067K20			Red	Ticona		White Chroma Color White 8C-902-CC
Purple	MT24U01 MT24U01PURP2607C			Purple	Chroma Color 4T3309603 2607C		
Yellow	MT24U01 MT24U01CL34074K20			Yellow	Celcon M90-07 CL34074K20		
Cream	MT24U01 MT24U01CB34075K20			Cream	Celcon M90-07 CB34075K20		

MOLDED PARTS:
 GATES, PARTING LINES, AND FLASH PER QUALITY CRITERIA

PROPRIETARY AND CONFIDENTIAL
 THE INFORMATION CONTAINED IN THIS DRAWING IS SOLE PROPERTY OF HALKEY-ROBERTS CORPORATION ST. PETERSBURG, FL. ANY REPRODUCTION IN PART OR AS A WHOLE WITHOUT THE WRITTEN PERMISSION OF HALKEY-ROBERTS CORPORATION IS PROHIBITED.

DRAWN BY	M.S.	DATE	04/04/96	<div style="font-size: 2em; font-weight: bold;">HR® Halkey-Roberts®</div>
APPROVED BY	J.W.	DATE	04/04/96	
MATERIAL	SEE NOTES PG 2.			
FINISH	N/A			TITLE <div style="font-size: 1.2em; font-weight: bold;">TUBING CLAMP MICRO</div>
UNLESS OTHERWISE SPECIFIED: DIMENSIONS ARE IN INCHES TOLERANCES: ANGULAR: ± 1° TWO PLACE DECIMAL ± .01 THREE PLACE DECIMAL ± .005				SIZE <div style="font-size: 1.2em; font-weight: bold;">A</div>
THIRD ANGLE PROJECTION 				DRAWING NO. <div style="font-size: 1.2em; font-weight: bold;">C340TSXX</div>
				SCALE <div style="font-weight: bold;">2:1</div>
DO NOT SCALE DRAWING				REV <div style="font-size: 1.2em; font-weight: bold;">AA</div>
				SHEET <div style="font-weight: bold;">2 OF 2</div>